

FLOOR PLANS CAPACITY CHARTS

THE WESTIN
COPLEY PLACE
BOSTON



MEETING SPACE OVERVIEW, PART ONE

10 Huntington Avenue
Boston, Massachusetts 02116
T 617.262.9600 F 617.424.7483
E westincopley@westin.com
westincopleyplaceboston.com

THE WESTIN
COPLEY PLACE
BOSTON

SEVENTH FLOOR

1. DEFENDER
2. EMPIRE
3. GREAT REPUBLIC
4. HELICON
5. MASTIFF
6. NORTHSTAR
7. PARLIAMENT
8. ADAMS
9. BALTIC
10. COURIER

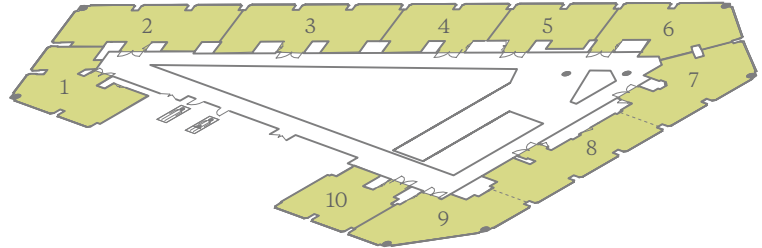

FOURTH FLOOR

1. AMERICA BALLROOM
2. AMERICA BALLROOM FOYER
3. INDEPENDENCE
4. CONVENTION OFFICE

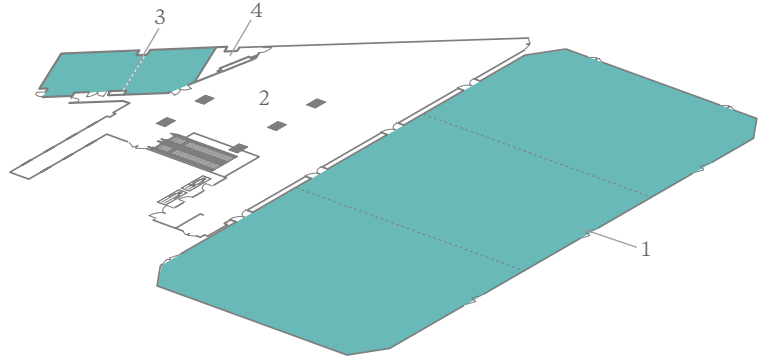

THIRD FLOOR

1. ESSEX BALLROOM
2. ESSEX BALLROOM FOYER
3. ST. GEORGE
4. STAFFORDSHIRE
5. STAFFORDSHIRE FOYER

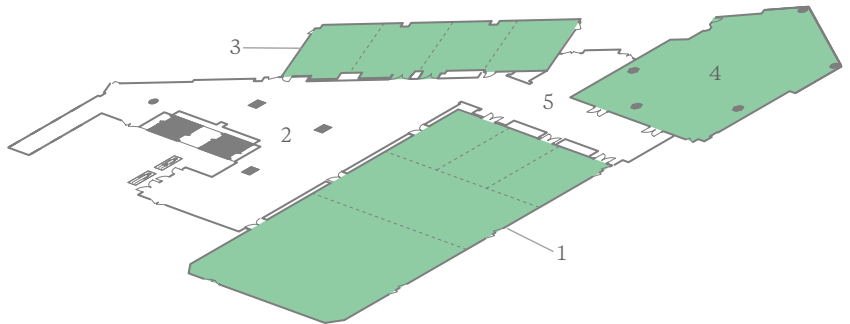

ROOMS AT A GLANCE

| | |
|-------------------------------|---|
| TOTAL GUEST ROOMS | 803 |
| TOTAL MEETING ROOMS | 32 |
| LARGEST MEETING ROOM CAPACITY | 2,000 |
| LARGEST MEETING ROOM SIZE | 1,425 m ² / 15,337 ft ² |

Additional spaces for meetings and events, not displayed here, may also be available. Contact your hotel representative for more information.

This document contains approximate measurements and square footage that are for illustrative purposes only. We cannot guarantee the floor plan accuracy or completeness, therefore encourage you to review the space to make sure it is suitable for your event.

MEETING SPACE OVERVIEW, PART TWO

10 Huntington Avenue
Boston, Massachusetts 02116
T 617.262.9600 F 617.424.7483
E westincopley@westin.com
westincopleyplaceboston.com

THE WESTIN
COPLEY PLACE
BOSTON

SECOND FLOOR

1. NEWBURY
2. GLOUCESTER
3. HUNTINGTON
4. HUNTINGTON HALL

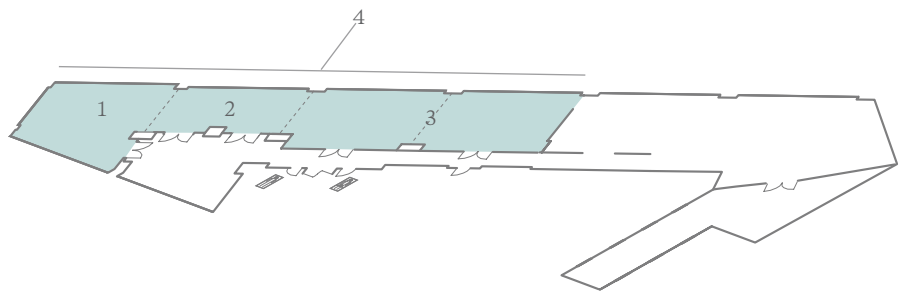

GROUND FLOOR

1. HARBOUR/IPSWICH/ROCKPORT
2. HARBOUR
3. IPSWICH
4. ROCKPORT

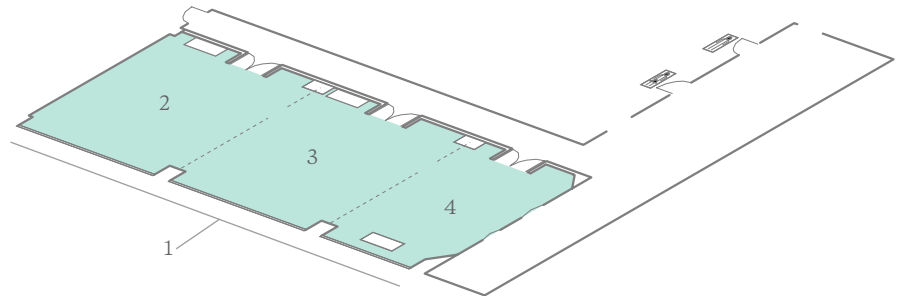

ROOMS AT A GLANCE

| | |
|-------------------------------|---|
| TOTAL GUEST ROOMS | 803 |
| TOTAL MEETING ROOMS | 32 |
| LARGEST MEETING ROOM CAPACITY | 2,000 |
| LARGEST MEETING ROOM SIZE | 1,425 m ² / 15,337 ft ² |

Additional spaces for meetings and events, not displayed here, may also be available. Contact your hotel representative for more information.

This document contains approximate measurements and square footage that are for illustrative purposes only. We cannot guarantee the floor plan accuracy or completeness, therefore encourage you to review the space to make sure it is suitable for your event.

MEETING SPACE SEVENTH FLOOR

10 Huntington Avenue
Boston, Massachusetts 02116
T 617.262.9600 F 617.424.7483
E westincopley@westin.com
westincopleyplaceboston.com

THE WESTIN

COPLEY PLACE
BOSTON

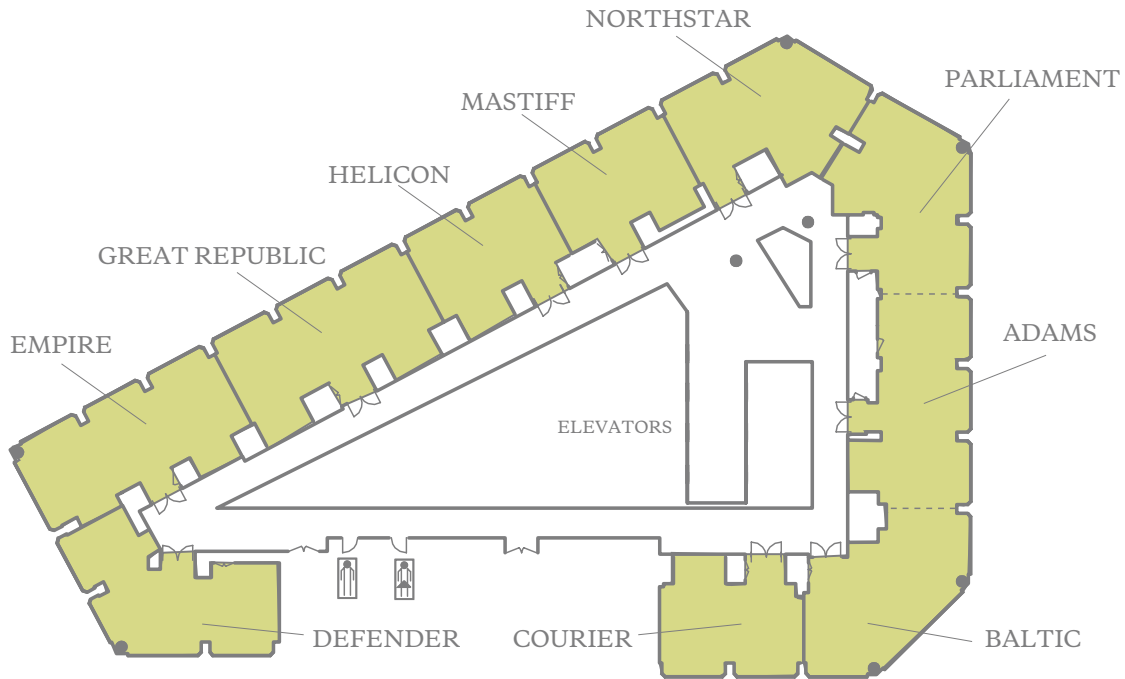

| | DIMENSIONS | AREA (SQ. FT.) | MAX CEILING HEIGHT | THEATER | THEATER CHEVRON | CLASSROOM | CLASSROOM CHEVRON | BANQUET | BANQUET CHEVRON | CONFERENCE | U-SHAPE | HOLLOW SQ. | RECEPTION |
|---------------------------|------------|----------------|--------------------|---------|-----------------|-----------|-------------------|---------|-----------------|------------|---------|------------|-----------|
| ■ COURIER | 24' X 28' | 615 | 8.3' | 41 | — | 26 | — | 41 | — | 20 | 20 | 22 | 41 |
| ■ DEFENDER | 30' X 45' | 797 | 8.2' | 59 | — | 41 | — | 59 | — | 28 | 23 | 28 | 59 |
| ■ EMPIRE | 23' X 45' | 902 | 8.2' | 64 | — | 49 | — | 64 | — | 40 | 40 | 40 | 64 |
| ■ GREAT REPUBLIC | 24' X 43' | 939 | 8.2' | 64 | — | 46 | — | 64 | — | 38 | 38 | 30 | 64 |
| ■ HELICON | 24' X 28' | 617 | 8.3' | 43 | — | 26 | — | 43 | — | 16 | 22 | 22 | 43 |
| ■ MASTIFF | 24' X 28' | 606 | 8.2' | — | — | — | — | 43 | — | 14 | — | — | 63 |
| ■ NORTH STAR | 29' X 40' | 813 | 8.2' | 56 | — | 30 | — | 56 | — | 28 | 24 | 24 | 56 |
| ■ PARLIAMENT/ADAMS/BALTIC | 34' X 117' | 2,529 | 8.3' | — | — | — | — | 90 | — | 90 | 87 | 84 | 175 |
| ■ ADAMS | 24' X 43' | 891 | 8.3' | 63 | 40 | 42 | 30 | 40 | 50 | 36 | 33 | 30 | 64 |
| ■ ADAMS/BALTIC | 34' X 77' | 1,697 | 8.3' | 102 | — | 66 | — | 70 | — | 54 | 45 | 48 | 119 |
| ■ BALTIC | 33' X 34' | 806 | 8.3' | 56 | — | 39 | — | 60 | 60 | 18 | 15 | 22 | 55 |
| ■ PARLIAMENT | 30' X 40' | 833 | 8.3' | 51 | — | 27 | — | 30 | — | 24 | 21 | 24 | 56 |
| ■ PARLIAMENT/ADAMS | 30' X 83' | 1,723 | 8.3' | 120 | — | 60 | — | 70 | — | 66 | 69 | 66 | 120 |

This document contains approximate measurements and square footage that are for illustrative purposes only. We cannot guarantee the floor plan accuracy or completeness, therefore encourage you to review the space to make sure it is suitable for your event.

MEETING SPACE FOURTH FLOOR

10 Huntington Avenue
Boston, Massachusetts 02116
T 617.262.9600 F 617.424.7483
E westincopley@westin.com
westincopleyplaceboston.com

THE WESTIN

COPLEY PLACE
BOSTON

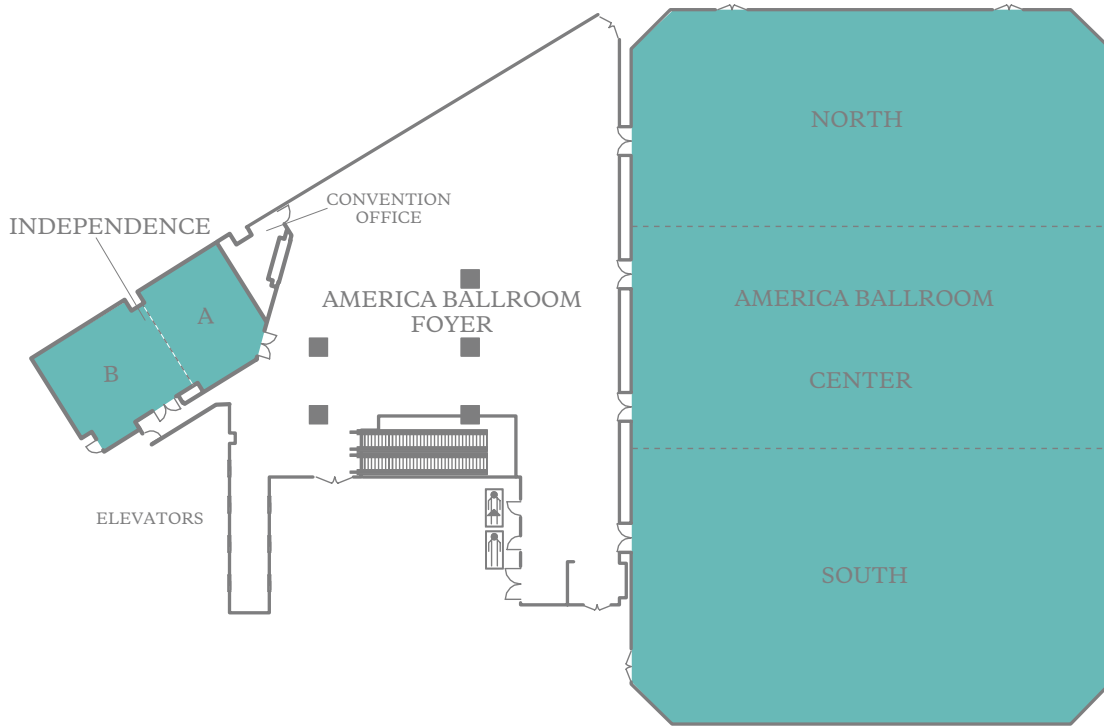

| | DIMENSIONS | AREA (SQ. FT.) | MAX CEILING HEIGHT | THEATER | THEATER CHEVRON | CLASSROOM | CLASSROOM CHEVRON | BANQUET | BANQUET CHEVRON | CONFERENCE | U-SHAPE | HOLLOW SQ. | RECEPTION |
|--------------------------|-------------|----------------|--------------------|---------|-----------------|-----------|-------------------|---------|-----------------|------------|---------|------------|-----------|
| ■ AMERICA BALLROOM | 102' X 152' | 15,329 | 16.3' | 1,800 | — | 970 | — | 1,300 | — | — | — | — | 2,000 |
| ■ AMERICA BALLROOM FOYER | 128' X 106' | 6,668 | 12' | — | — | — | — | — | — | — | — | — | 600 |
| ■ AMERICA CENTER | 102' X 46' | 4,710 | 16.3' | 450 | — | 250 | — | 320 | — | 88 | 70 | 80 | 500 |
| ■ AMERICA CENTER & NORTH | 102' X 93' | 9,398 | 16.3' | 1,012 | 950 | 609 | 540 | 710 | 800 | 90 | 120 | 150 | 989 |
| ■ AMERICA NORTH | 102' X 46' | 4,662 | 16.3' | 500 | — | 252 | — | 360 | — | 90 | 70 | 80 | 500 |
| ■ AMERICA SOUTH | 102' X 59' | 5,922 | 16.3' | 500 | — | 306 | — | 450 | — | 90 | 78 | 90 | 600 |
| ■ AMERICA SOUTH & CENTER | 102' X 106' | 10,668 | 16.3' | 1,332 | 1,102 | 711 | 588 | 900 | 1,250 | 90 | 126 | 162 | 1,122 |
| ■ CONVENTION OFFICE | 16' X 22' | 176 | 9.6' | — | — | — | — | — | — | — | — | — | 43 |
| ■ INDEPENDENCE | 28' X 50' | 1,308 | 10' | 90 | — | 70 | — | 80 | — | 32 | 30 | 36 | 120 |
| ■ INDEPENDENCE A | 28' X 23' | 608 | 10' | 60 | — | 40 | — | 50 | — | 26 | 24 | 28 | 70 |
| ■ INDEPENDENCE B | 27' X 27' | 700 | 10' | 50 | — | 30 | — | 40 | — | 24 | 22 | 28 | 50 |

This document contains approximate measurements and square footage that are for illustrative purposes only. We cannot guarantee the floor plan accuracy or completeness, therefore encourage you to review the space to make sure it is suitable for your event.

MEETING SPACE THIRD FLOOR

10 Huntington Avenue
Boston, Massachusetts 02116
T 617.262.9600 F 617.424.7483
E westincopley@westin.com
westincopleyplaceboston.com

THE WESTIN

COPLEY PLACE
BOSTON

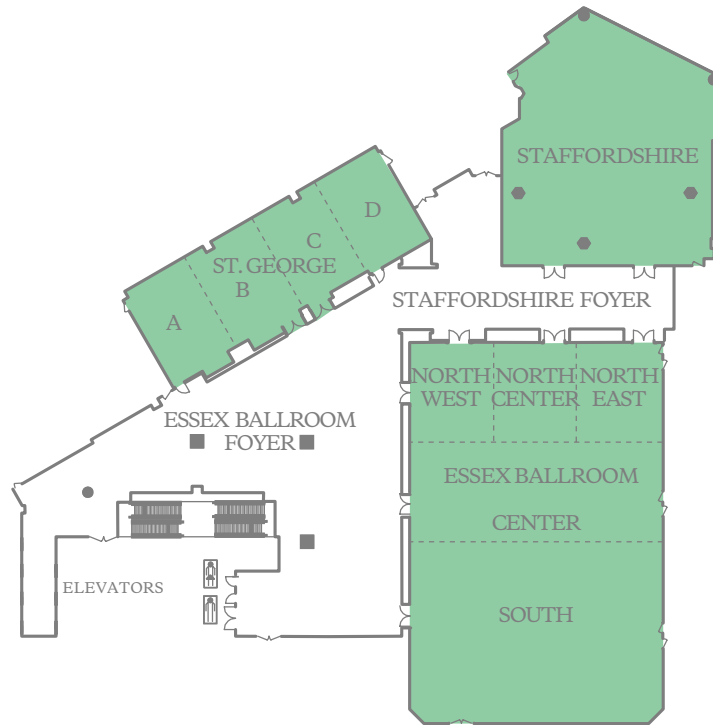

| | DIMENSIONS | AREA (SQ. FT.) | MAX CEILING HEIGHT | THEATER | THEATER CHEVRON | CLASSROOM | CLASSROOM CHEVRON | BANQUET | BANQUET CHEVRON | CONFERENCE | U-SHAPE | HOLLOW SQ. | RECEPTION |
|-----------------------------------|-------------|----------------|--------------------|---------|-----------------|-----------|-------------------|---------|-----------------|------------|---------|------------|-----------|
| ■ ESSEX BALLROOM | 74' X 111' | 8,136 | 14.3' | 850 | — | 428 | — | 590 | — | — | — | — | 1,030 |
| ■ ESSEX BALLROOM FOYER | 110' X 116' | 5,931 | 11.2' | — | — | — | — | — | — | — | — | — | 600 |
| ■ ESSEX CENTER | 74' X 29' | 2,135 | 14.3' | 200 | — | 100 | — | 170 | — | 66 | 60 | 76 | 270 |
| ■ ESSEX CENTER & NORTH | 74' X 58' | 4,262 | 14.3' | 459 | 364 | 273 | 240 | 300 | 320 | 60 | 75 | 90 | 448 |
| ■ ESSEX CENTER & SOUTH | 74' X 82' | 6,009 | 14.3' | 638 | 544 | 390 | 300 | 420 | 490 | 66 | 87 | 114 | 632 |
| ■ ESSEX NORTH | 74' X 29' | 2,127 | 14.3' | 216 | 144 | 126 | 90 | 140 | 200 | 66 | 60 | 72 | 270 |
| ■ ESSEX NORTH CENTER | 24' X 29' | 706 | 14.3' | 50 | — | 40 | — | 50 | — | 24 | 28 | 32 | 80 |
| ■ ESSEX NORTH CENTER & NORTH EAST | 49' X 29' | 1,422 | 14.3' | 110 | 88 | 72 | 63 | 80 | 90 | 42 | 42 | 48 | 149 |
| ■ ESSEX NORTH CENTER & NORTH WEST | 49' X 29' | 1,411 | 14.3' | 144 | — | 72 | — | 80 | 100 | 42 | 45 | 48 | 148 |
| ■ ESSEX NORTH EAST | 25' X 29' | 715 | 14.3' | 50 | — | 40 | — | 50 | — | 24 | 28 | 30 | 80 |
| ■ ESSEX NORTH WEST | 25' X 29' | 707 | 14.3' | 50 | — | 40 | — | 50 | — | 24 | 28 | 30 | 80 |
| ■ ESSEX SOUTH | 74' X 53' | 3,874 | 14.3' | 380 | — | 200 | — | 240 | — | 64 | 60 | 78 | 490 |
| ■ ST. GEORGE | 34' X 87' | 2,721 | 11.1' | 200 | — | 140 | — | 220 | — | 72 | 69 | 72 | 300 |
| ■ ST. GEORGE A | 34' X 22' | 718 | 11.1' | 50 | — | 40 | — | 50 | — | 24 | 28 | 32 | 80 |
| ■ ST. GEORGE A - B | 34' X 45' | 1,435 | 11.1' | 100 | — | 80 | — | 110 | — | 36 | 38 | 48 | 160 |
| ■ ST. GEORGE A - C | 34' X 66' | 2,063 | 11.1' | 210 | 152 | 72 | 72 | 100 | 170 | 48 | 54 | 54 | 217 |
| ■ ST. GEORGE B | 34' X 23' | 717 | 11.1' | 50 | — | 40 | — | 50 | — | 24 | 28 | 32 | 80 |
| ■ ST. GEORGE B - C | 34' X 43' | 1,345 | 11.1' | 100 | — | 75 | — | 110 | — | 36 | 37 | 48 | 160 |
| ■ ST. GEORGE B - D | 34' X 64' | 2,003 | 11.1' | 180 | 140 | 72 | 81 | 180 | 150 | 54 | 54 | 54 | 210 |
| ■ ST. GEORGE C | 32' X 21' | 632 | 11.1' | 49 | — | 30 | — | 40 | 40 | 24 | 24 | 24 | 75 |
| ■ ST. GEORGE C - D | 32' X 42' | 1,289 | 11.1' | 100 | — | 75 | — | 110 | — | 36 | 37 | 46 | 160 |
| ■ ST. GEORGE D | 32' X 21' | 658 | 11.1' | 50 | — | 40 | — | 50 | — | 24 | 28 | 30 | 80 |
| ■ STAFFORDSHIRE | 75' X 64' | 3,937 | 13.2' | 270 | — | 165 | — | 300 | — | 54 | 62 | 78 | 400 |
| ■ STAFFORDSHIRE FOYER | 50' X 81' | 2,111 | 10.5' | — | — | — | — | — | — | — | — | — | 222 |

This document contains approximate measurements and square footage that are for illustrative purposes only. We cannot guarantee the floor plan accuracy or completeness, therefore encourage you to review the space to make sure it is suitable for your event.

MEETING SPACE SECOND FLOOR

10 Huntington Avenue
Boston, Massachusetts 02116
T 617.262.9600 F 617.424.7483
E westincopley@westin.com
westincopleyplaceboston.com

THE WESTIN

COPLEY PLACE
BOSTON

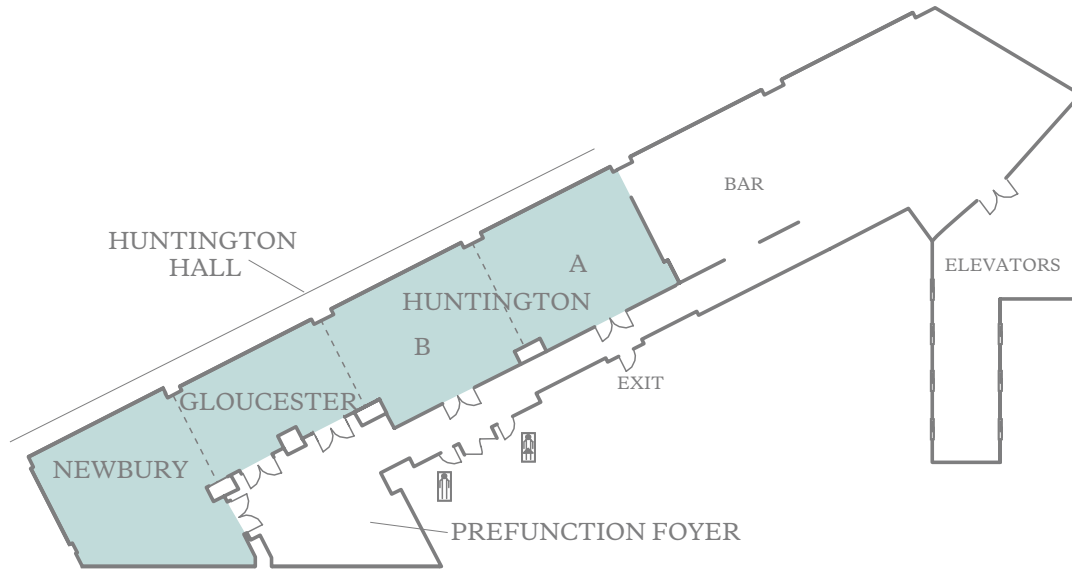

| | DIMENSIONS | AREA (SQ. FT.) | MAX CEILING HEIGHT | THEATER | THEATER CHEVRON | CLASSROOM | CLASSROOM CHEVRON | BANQUET | BANQUET CHEVRON | CONFERENCE | U-SHAPE | HOLLOW SQ. | RECEPTION |
|---|------------|----------------|--------------------|---------|-----------------|-----------|-------------------|---------|-----------------|------------|---------|------------|-----------|
| ■ HUNTINGTON HALL (NEWBURY/GLOUCESTER/HUNTINGTON) | 35' X 116' | 2,764 | 12' | — | — | 108 | — | 180 | 190 | 84 | — | — | 271 |
| ■ GLOUCESTER | 20' X 29' | 506 | 12' | 48 | — | 24 | — | 48 | — | 16 | 14 | 16 | 48 |
| ■ GLOUCESTER/HUNTINGTON | 25' X 87' | 1,925 | 12' | 110 | — | — | — | 120 | — | — | — | — | 140 |
| ■ HUNTINGTON | 25' X 59' | 1,374 | 12' | 100 | — | — | — | 72 | — | — | — | — | 100 |
| ■ HUNTINGTON A | 25' X 29' | 686 | 12' | 50 | — | 36 | — | 36 | — | 18 | 18 | 22 | 50 |
| ■ HUNTINGTON B | 25' X 29' | 688 | 12' | 50 | — | 36 | — | 36 | — | 18 | 18 | 22 | 50 |
| ■ NEWBURY | 35' X 28' | 768 | 12' | 48 | — | 36 | — | 50 | — | 20 | 24 | 24 | 48 |
| ■ NEWBURY/GLOUCESTER | 35' X 57' | 1,262 | 12' | 90 | — | 50 | — | 112 | — | 40 | 40 | 40 | 112 |
| ■ PREFUNCTION FOYER | 31' X 102' | 1,136 | 12' | — | — | — | — | — | — | — | — | — | 122 |

This document contains approximate measurements and square footage that are for illustrative purposes only. We cannot guarantee the floor plan accuracy or completeness, therefore encourage you to review the space to make sure it is suitable for your event.

MEETING SPACE GROUND FLOOR

10 Huntington Avenue
Boston, Massachusetts 02116
T 617.262.9600 F 617.424.7483
E westincopley@westin.com
westincopleyplaceboston.com

THE WESTIN

COPLEY PLACE
BOSTON

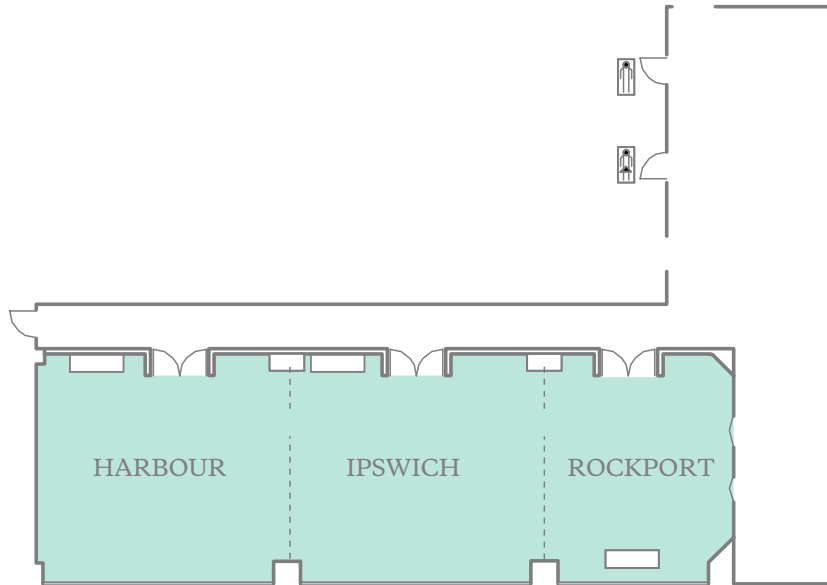

| | DIMENSIONS | AREA (SQ. FT.) | MAX CEILING HEIGHT | THEATER | THEATER CHEVRON | CLASSROOM | CLASSROOM CHEVRON | BANQUET | BANQUET CHEVRON | CONFERENCE | U-SHAPE | HOLLOW SQ. | RECEPTION |
|----------------------------|------------|----------------|--------------------|---------|-----------------|-----------|-------------------|---------|-----------------|------------|---------|------------|-----------|
| ■ HARBOUR/IPSWICH/ROCKPORT | 26' X 79' | 1,880 | 10' | — | — | — | — | 130 | — | — | — | — | 278 |
| ■ HARBOUR | 26' X 28' | 688 | 10' | 55 | — | 30 | — | 50 | 40 | 22 | 22 | 20 | 106 |
| ■ IPSWICH | 26' X 29' | 705 | 10' | 50 | — | 30 | — | 50 | 40 | 20 | 20 | 18 | 102 |
| ■ IPSWICH/HARBOUR | 26' X 57' | 1,393 | 10' | 117 | 78 | 66 | 42 | 100 | 90 | 42 | 48 | 48 | 146 |
| ■ ROCKPORT | 26' X 21' | 486 | 10' | 30 | — | 20 | — | 30 | — | 16 | 18 | 18 | 50 |
| ■ ROCKPORT/IPSWICH | 26' X 50' | 1,192 | 10' | 108 | — | 54 | — | 80 | 80 | 42 | 36 | 42 | 125 |

This document contains approximate measurements and square footage that are for illustrative purposes only. We cannot guarantee the floor plan accuracy or completeness, therefore encourage you to review the space to make sure it is suitable for your event.



10 Huntington Avenue
Boston, Massachusetts 02116
T 617.262.9600 F 617.424.7483
E westincopley@westin.com
westincopleyplaceboston.com

THE WESTIN
COPLEY PLACE
BOSTON